



American Samoa Medical Center Authority
LBJ Tropical Medical Center
P.O. Box LBJ Pago Pago AS 96799



ISSUANCE DATE: **May 28, 2024**

RFP NO.: **LBJ24.05 LBJ New Training Facility Design-Build Project**

Subject: **Addendum No. 3**

To all,

The LBJ Tropical Medical Center hereby issues Addendum No. 3 to amend Request for Proposals (RFP) requirements. This addendum is issued pursuant to the conditions of the RFP documents and is hereby made part of the RFP. The addendum serves to clarify, revise, and supersede information contained in the RFP. The Offeror must acknowledge receipt of this addendum in the appropriate space provided in the Addendum Form. Failure to do so may subject the Offeror to disqualification.

1. This RFP bid submission has been **“EXTENDED”** to now close on Friday, June 14, 2024 @ 2:00pm, local time.
2. This Project is **“LOCALLY FUNDED”** and not funded through ARPA Funds as initially posted.
3. Attached is a **“sample dimensional layout”** for level’s 1 & 2 and serves as illustrative purposes only. Also, a link will be provided on “website” and through “email” to access **“Survey Data”** & **“Sample Layout”** requested through Google Drive.

Should you have any questions or need clarifications, please contact the Director of Purchasing & Supply Chain – Frederick Ledoux via email frederick.ledoux@lbi.as or Procurement Contract Specialist – Shawn Togia via email shawn.togia@lbi.as or phone.

Sincerely,

CFO Sefanaia Kaumaitotoya
LBJTMC Chief Procurement Officer

Please acknowledge acceptance of this Addendum below:

LBJTMC Chief Procurement Officer

05/28/24
Date:

Contractor

Date



LBJ TRAINING FACILITY

Schematic Diagram of Spaces



Disclaimer: The below layout for the two floors is provided as an illustration only to give bidders an example of what LBJ is looking for. The layout and final floor plan will be collaborated between the winning bidder and LBJ. The winning bidder is responsible to provide options that would best fit the blocks listed below into the available lot at the site.

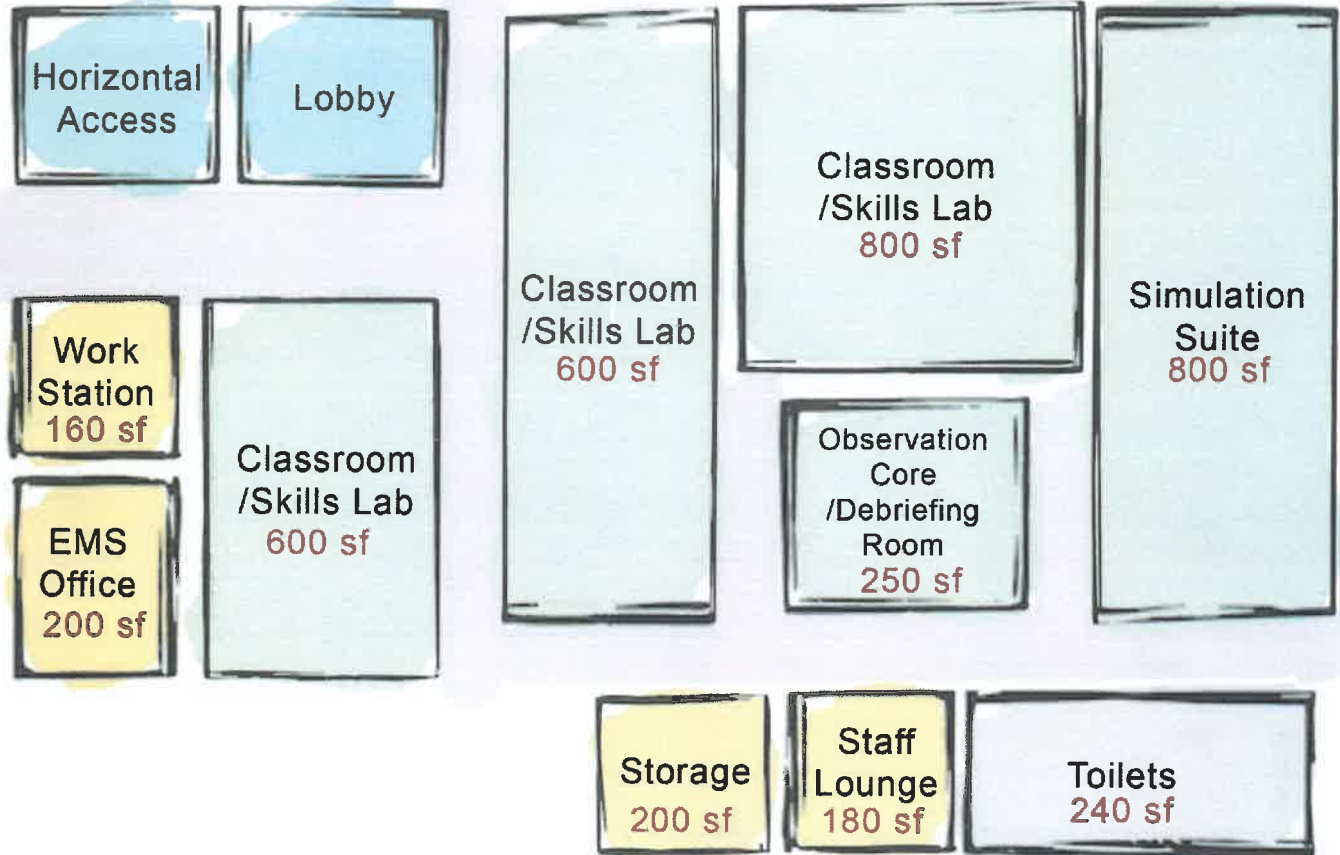

Level 1

Spaces=4,030 sf
 Access=(15%) 604.50 sf
 Total=4,634.50 sf

-  Public Zone
-  Learning Zone
-  Staff Zone
-  Toilets Hallways



LBJ TRAINING FACILITY

Schematic Diagram of Spaces

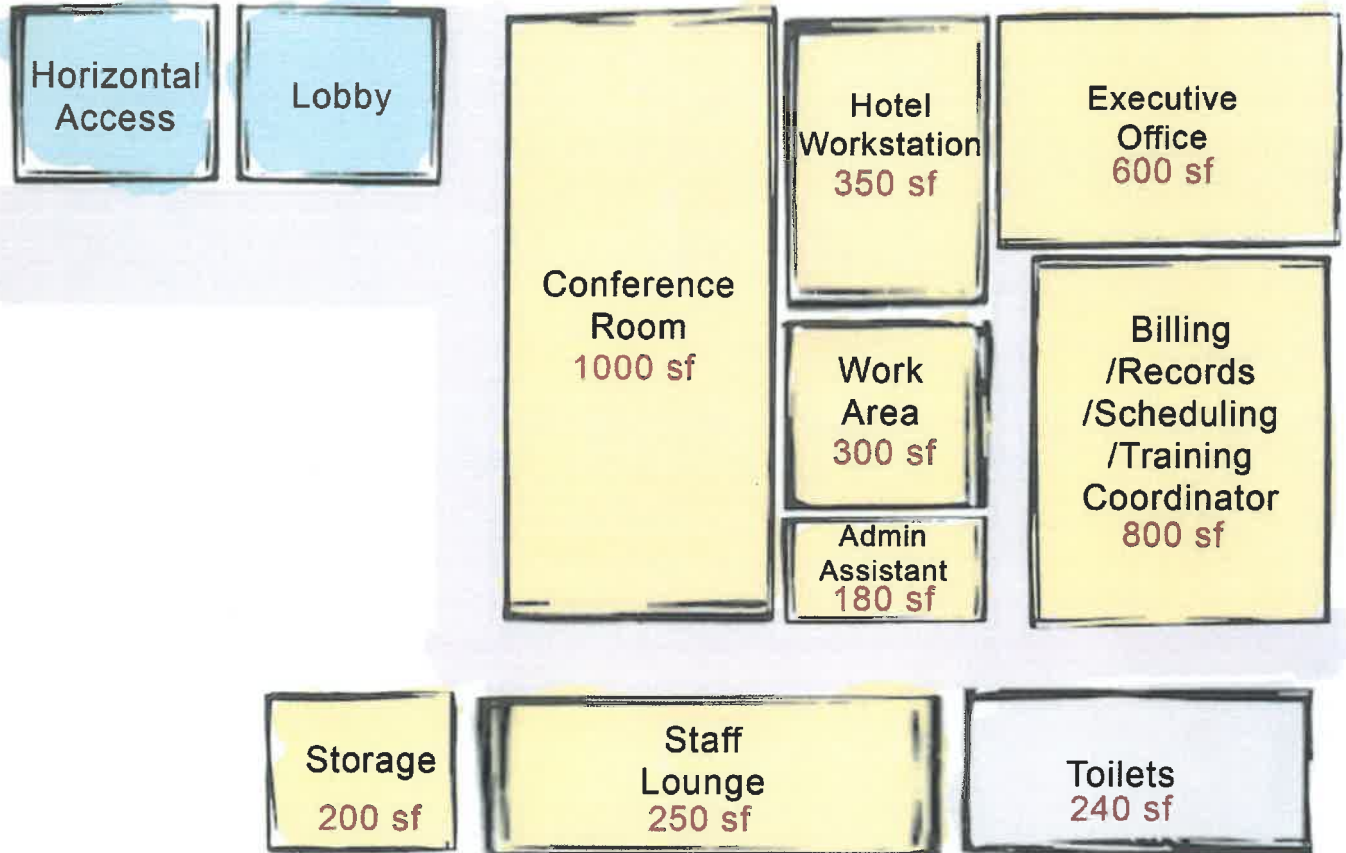

Level 2

Spaces=3,920 sf

Access=(15%) 588 sf

Total=4,508 sf

